

For reference only. See data sheet for the detailed specifications.

## Technical Specification



Frequency Range(GHz)	18.0 - 45.0
Gain(dBi)	20 Typ.
Polarization	Linear
3dB Beamwidth(deg)	E Plane: 23 - 9
	H Plane: 26 - 10
Cross Pol. Isolation(dB)	35 Typ.
VSWR	1.5:1 Typ.
	2.0:1 Max.
Output	Endlaunch 2.4mm-Female
Power Handling(W CW)	10 Max.
Material	Cu
Finish	Gold Plated and Passivation, Gray Paint
Size(mm)	55 x 55 x 128.2
Net Weight(Kg)	0.25 Around

## Outline Drawing (Size: mm)

Endlaunch 2.4mm-Female Output (P/N: LB-180450H-E2.4F)

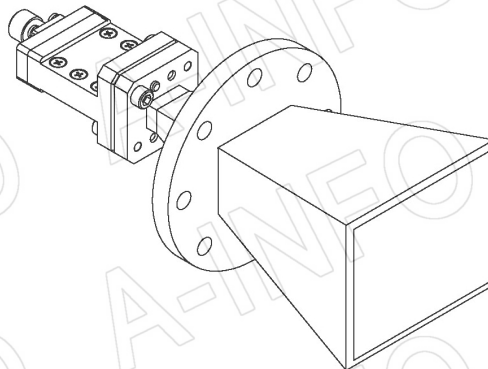
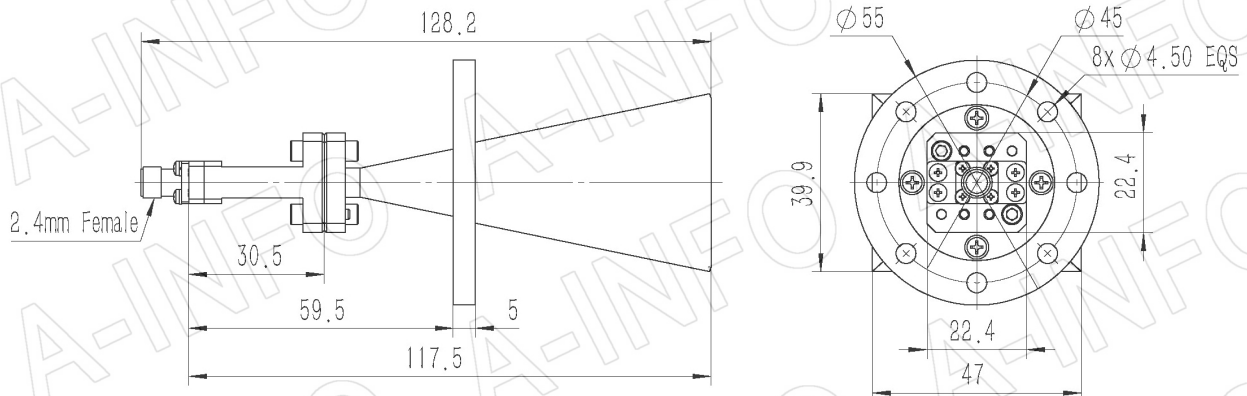

AINFO Inc.

Page 1 of 15

China(Beijing): Tel: (+86) 10-6266-7326,  
China(Chengdu): Tel: (+86) 28-8519-2786,  
USA: Tel: (+1) 949-639-9688,

(+86) 10-6266-7327 Fax: (+86) 10-6266-7379  
(+86) 28-8519-3044 Fax: (+86) 28-8519-3068  
(+1) 949-639-9608 Fax: (+1) 949-639-9670

Website: [www.ainfoinc.com](http://www.ainfoinc.com)  
Email: [sales@ainfoinc.com](mailto:sales@ainfoinc.com)

Endlaunch 2.4mm-Female Output with L Type Mounting Bracket (Option, P/N: LB-19-25-L2)

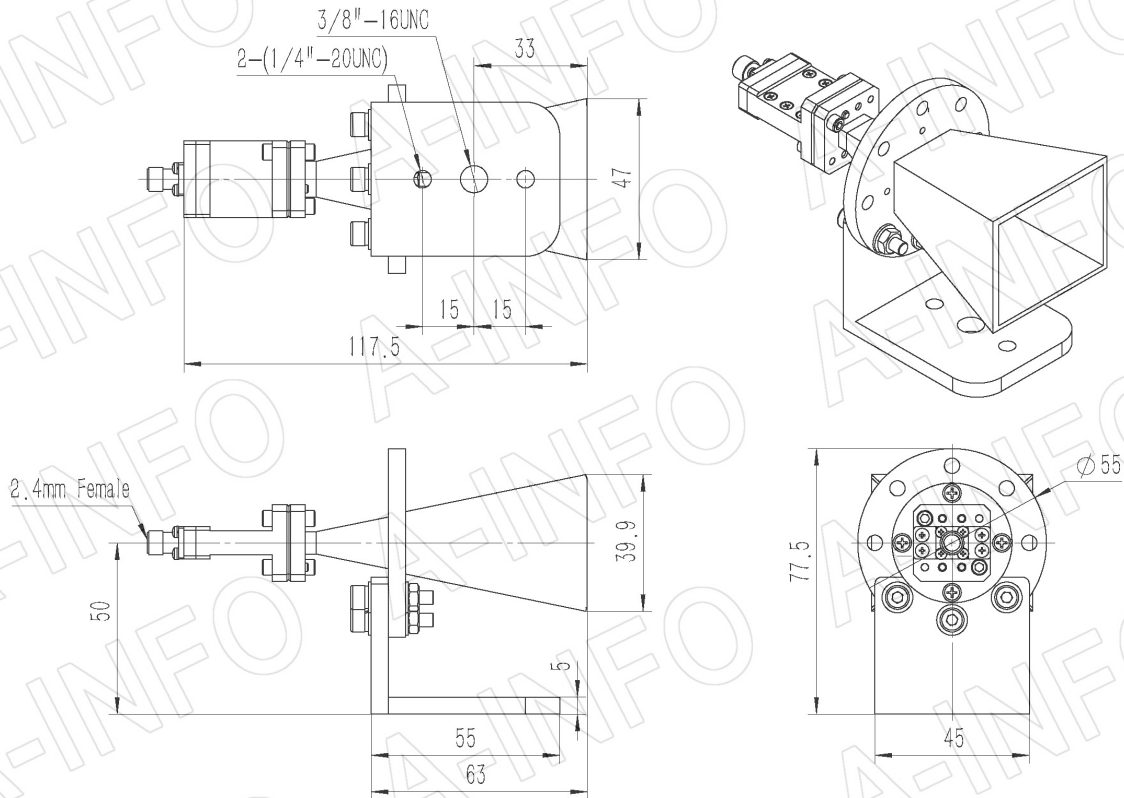

Endlaunch 2.4mm-Female Output with Radome (Option, P/N: LB-180450H-E2.4FSP0, Outdoor Application)

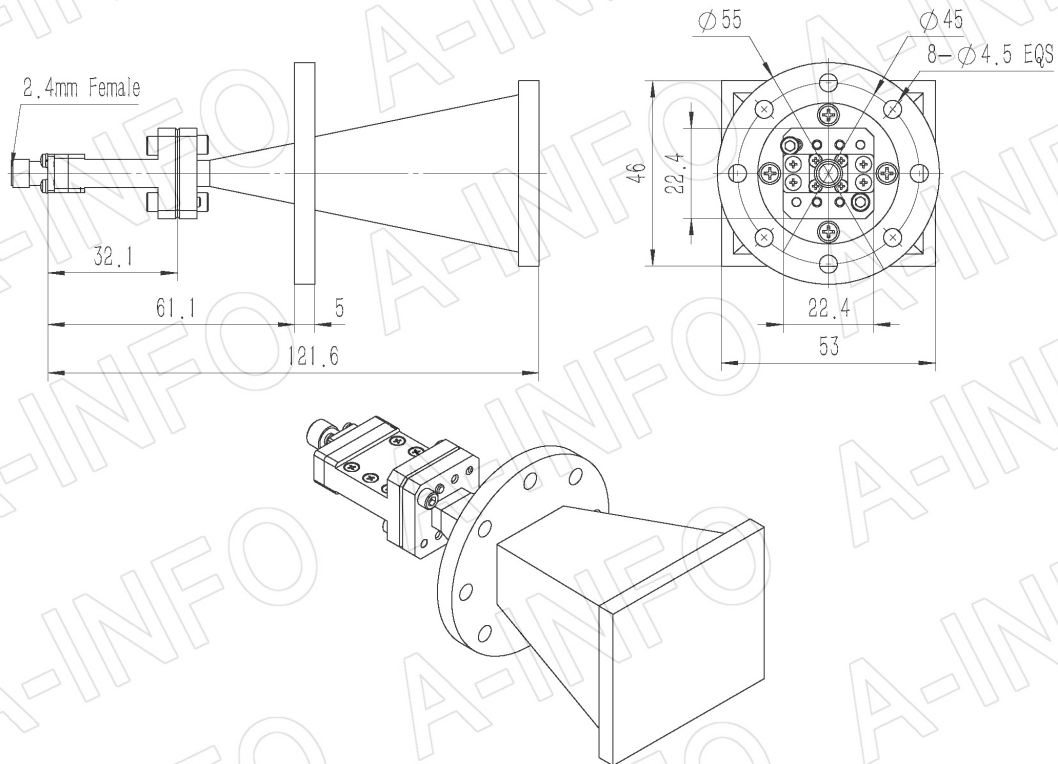

Endlaunch 2.4mm-Female Output with L Type Mounting Bracket & Radome (Option, P/N: LB-19-25-L2 & LB-180450H-E2.4FSPO, Outdoor Application)

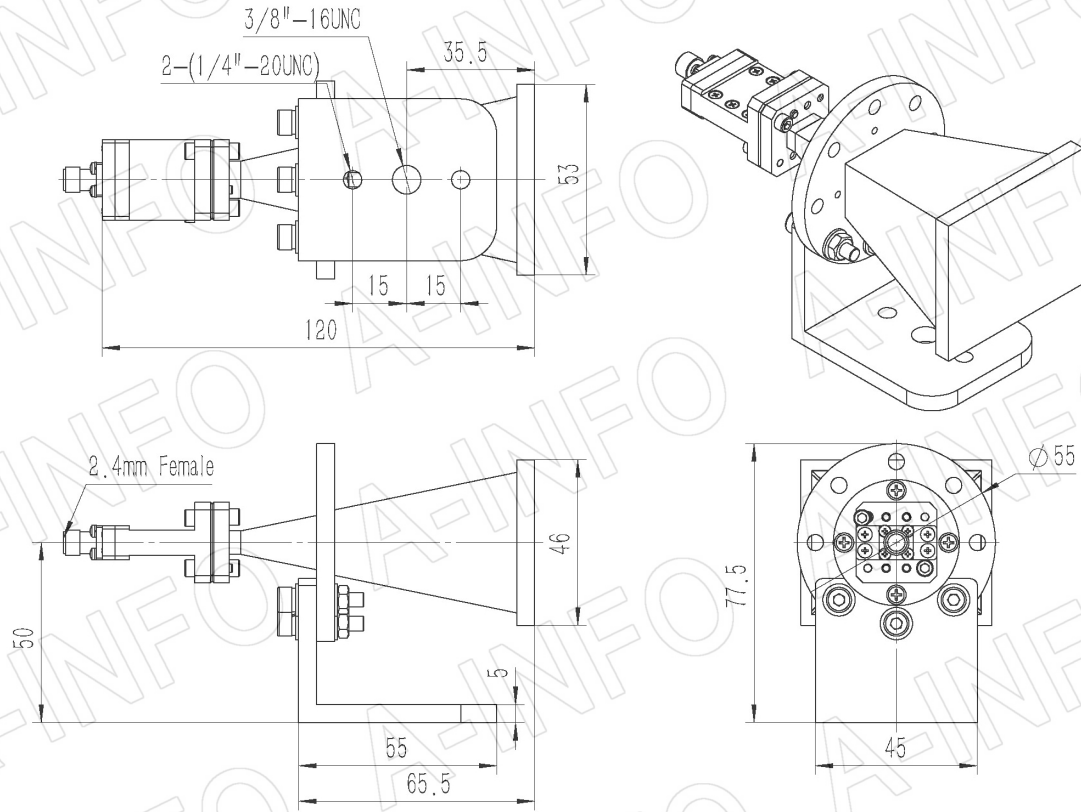

## Test Results

### 1. Gain

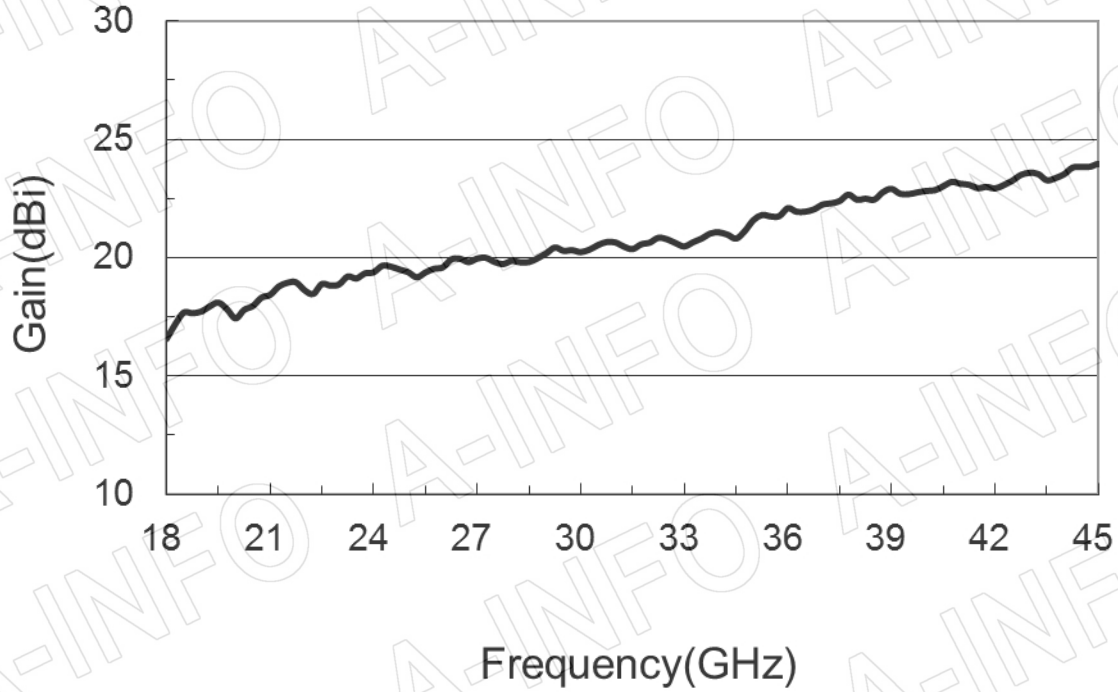

### 2. Antenna Factor

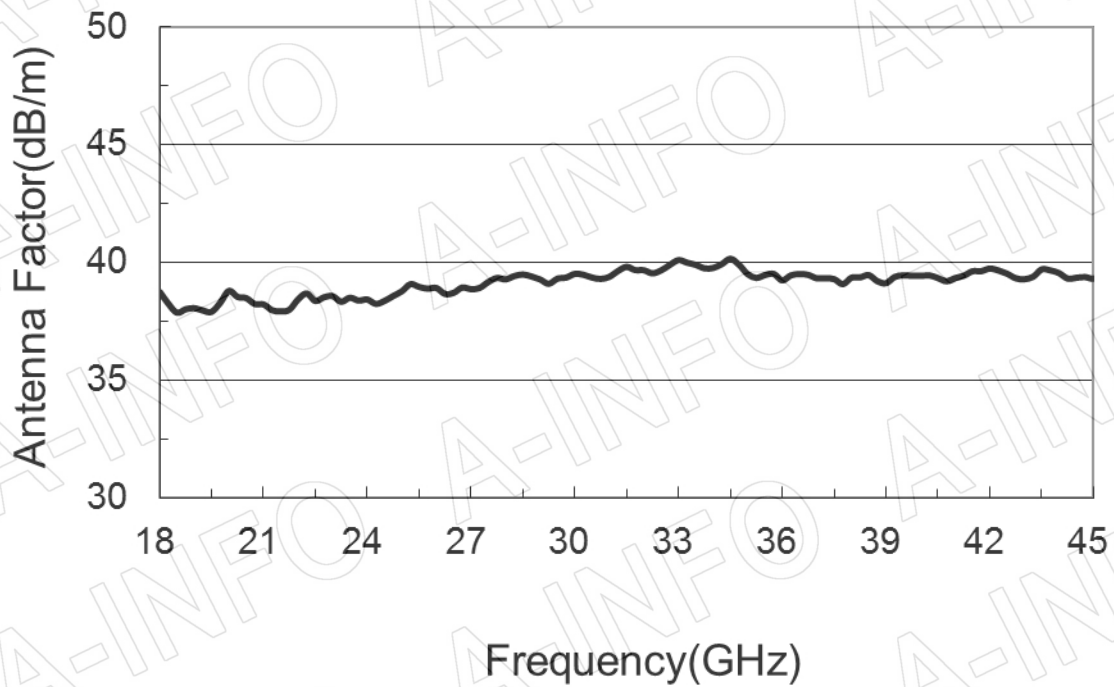

### 3. Cross Polarization Isolation

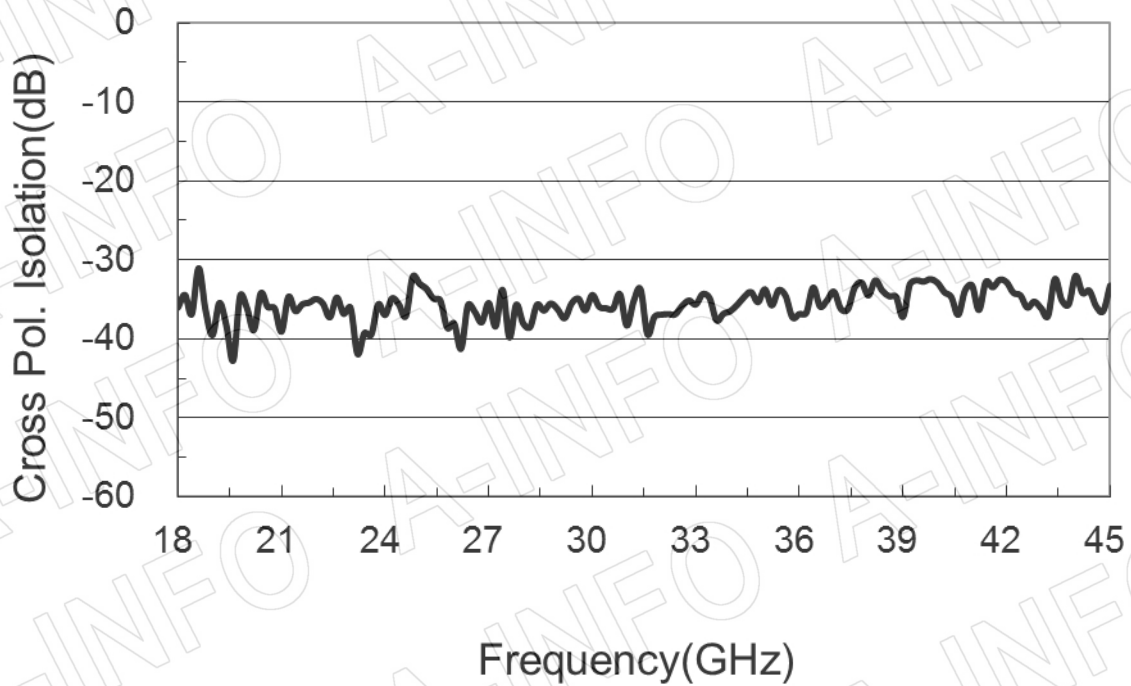

### 4. VSWR

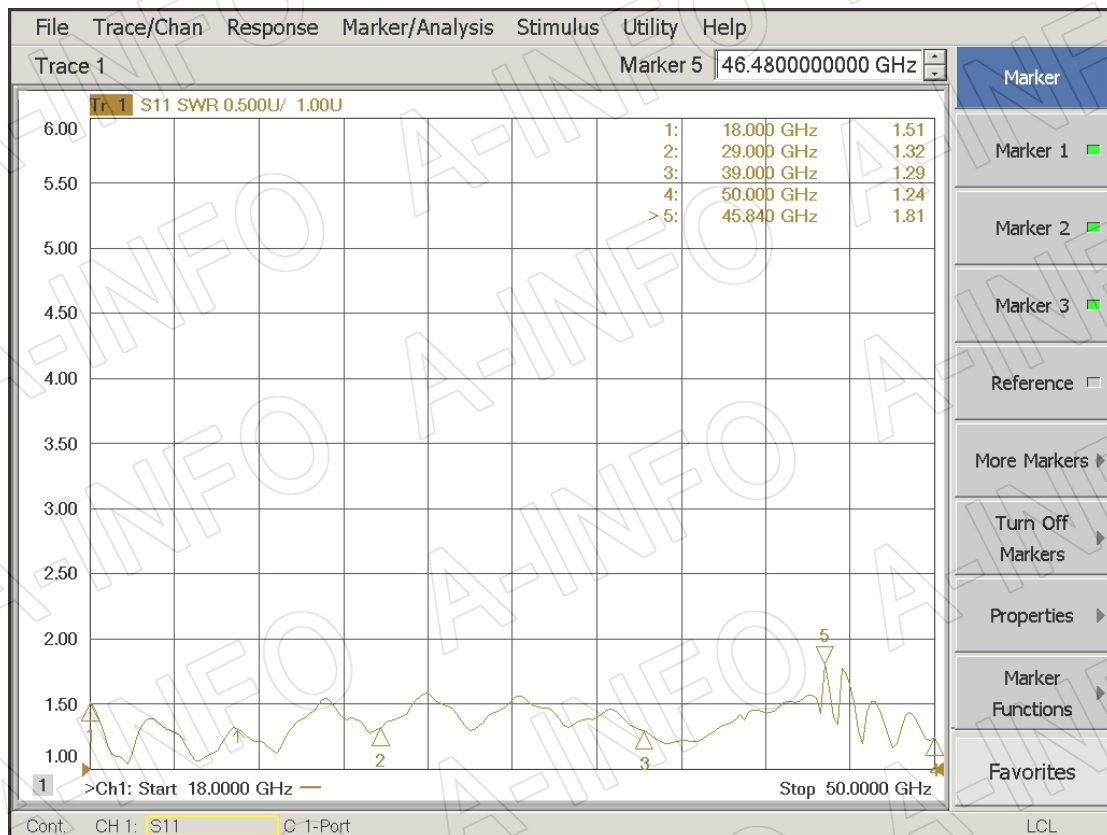

## 5. Pattern

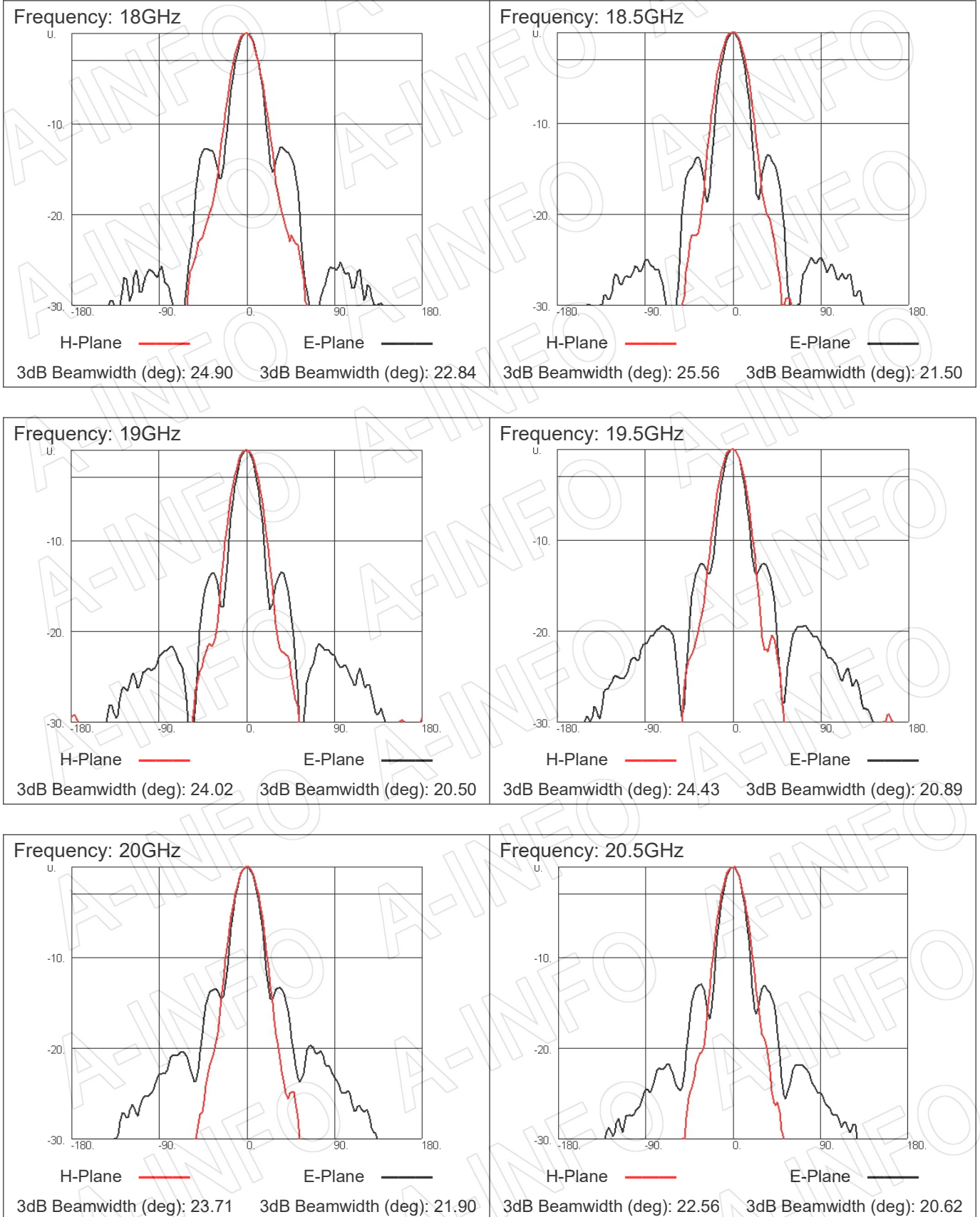

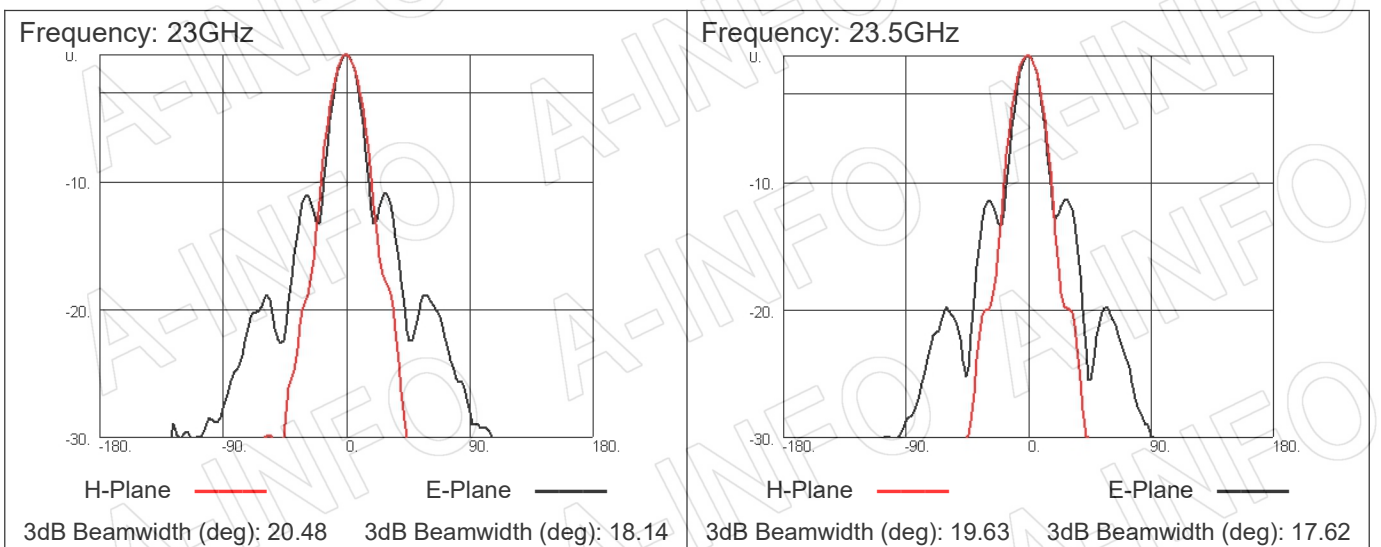
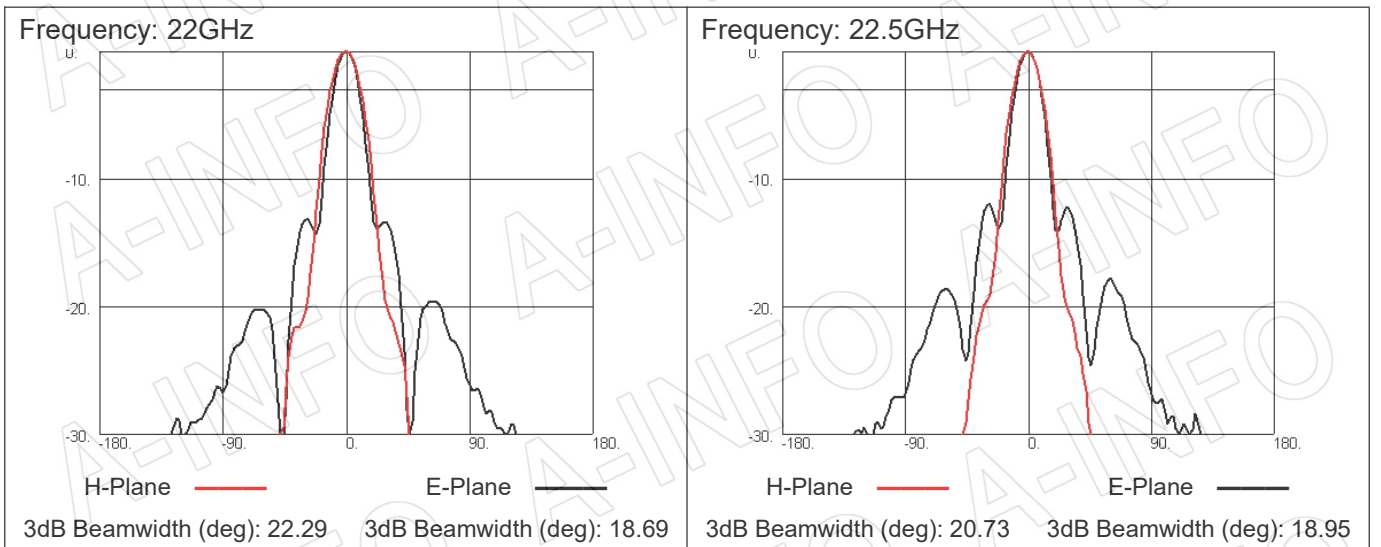
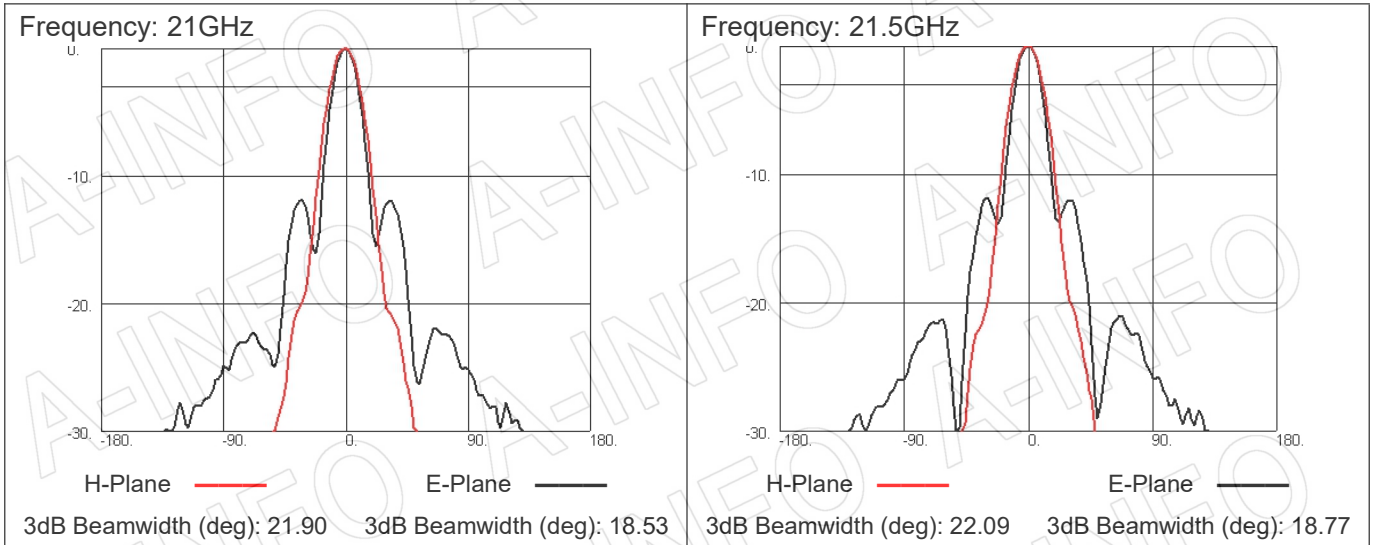

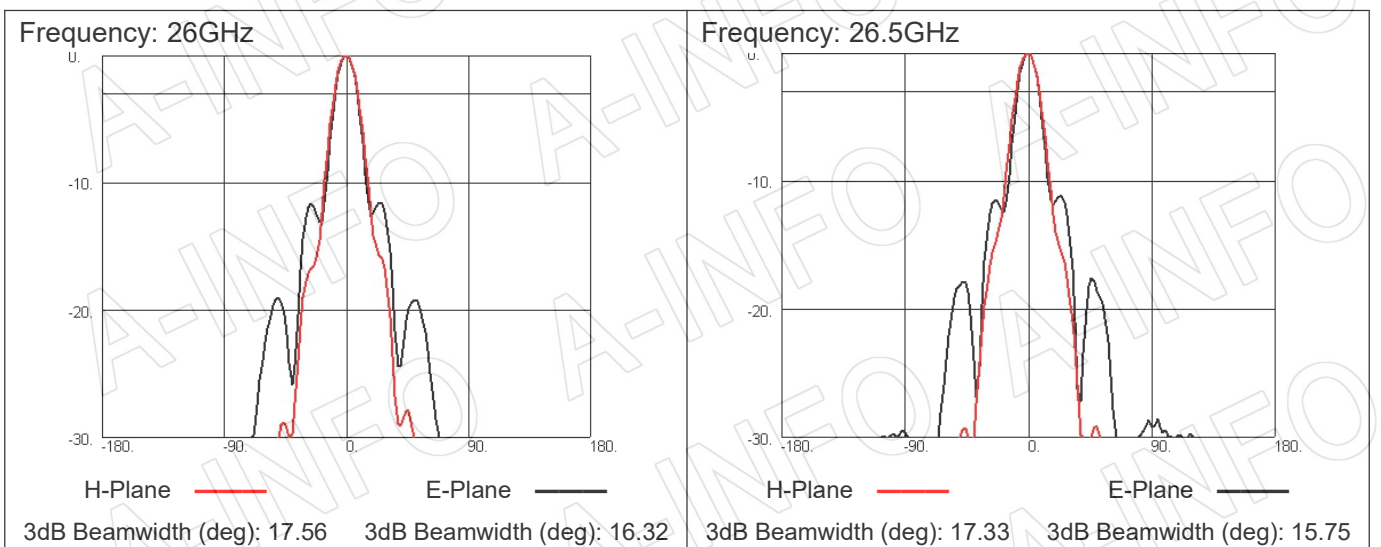
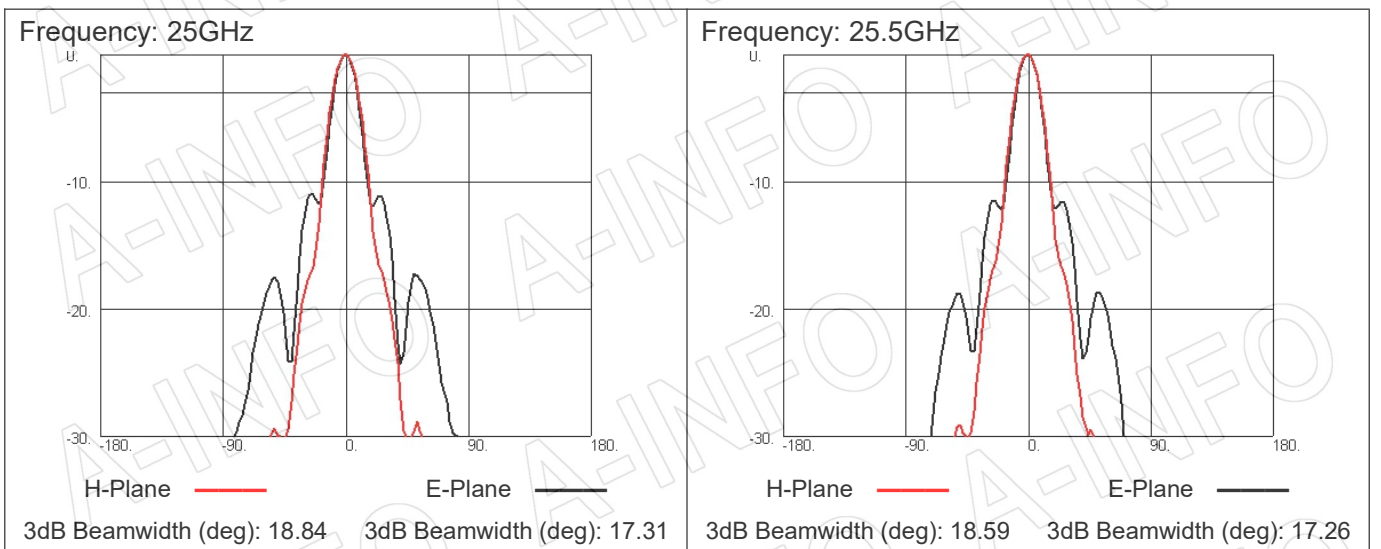
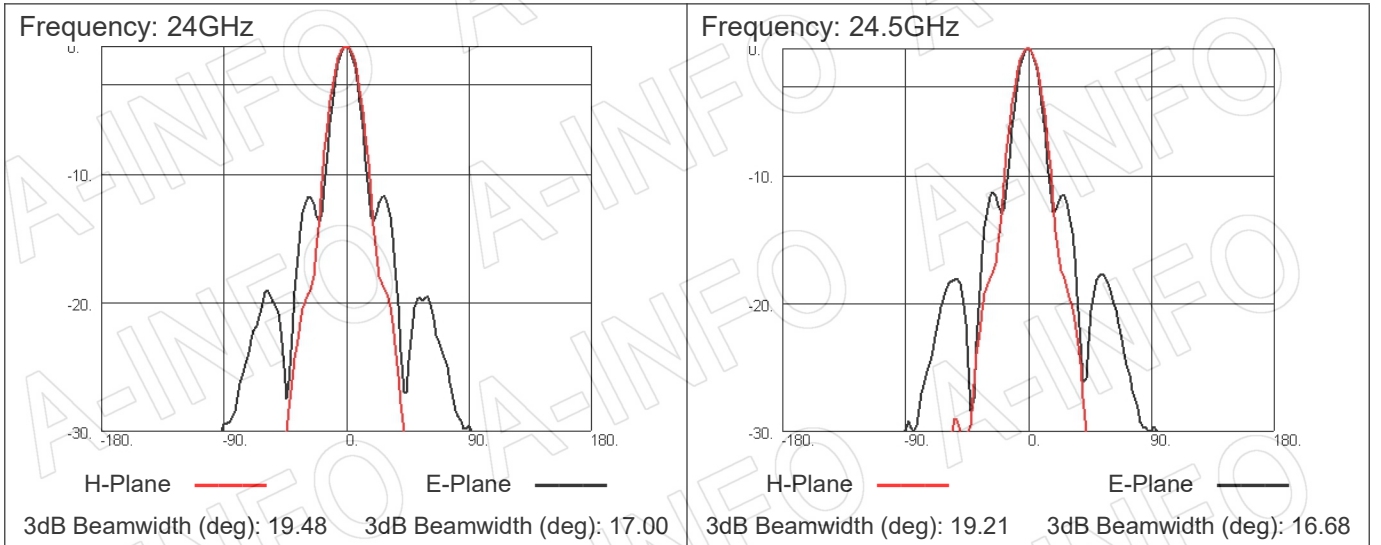



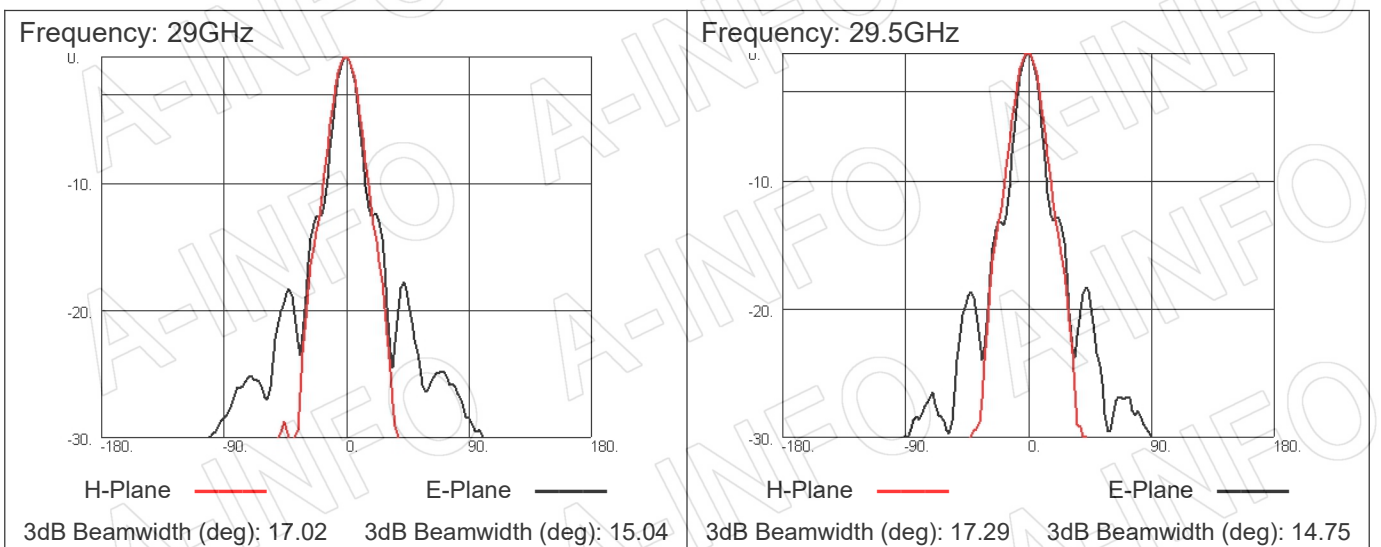
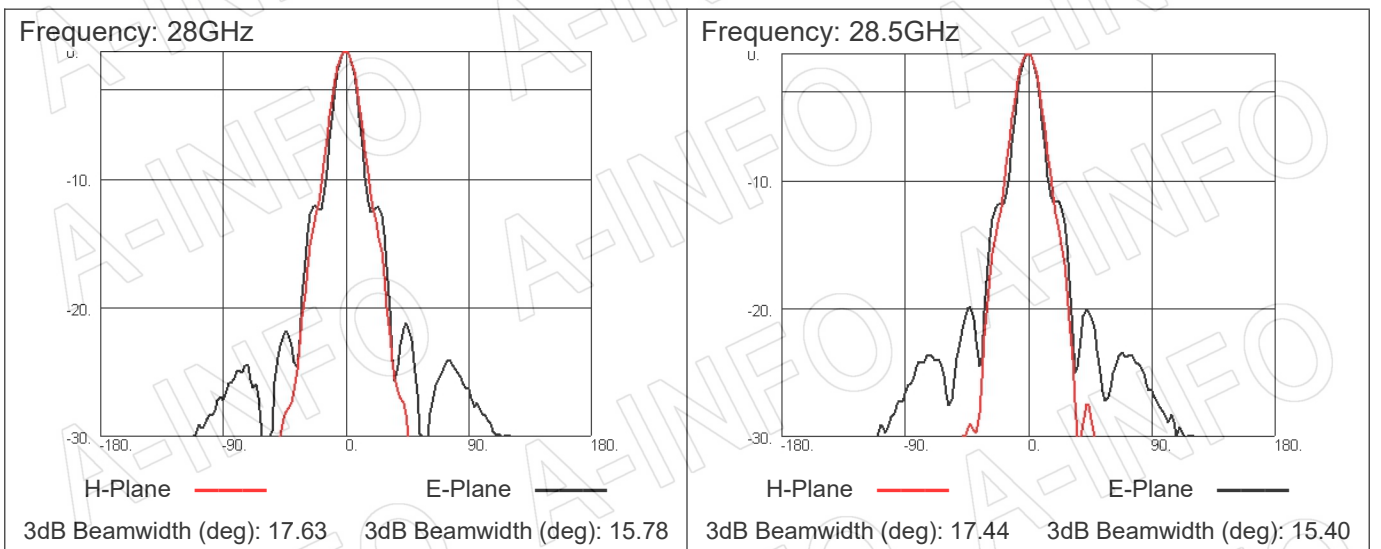
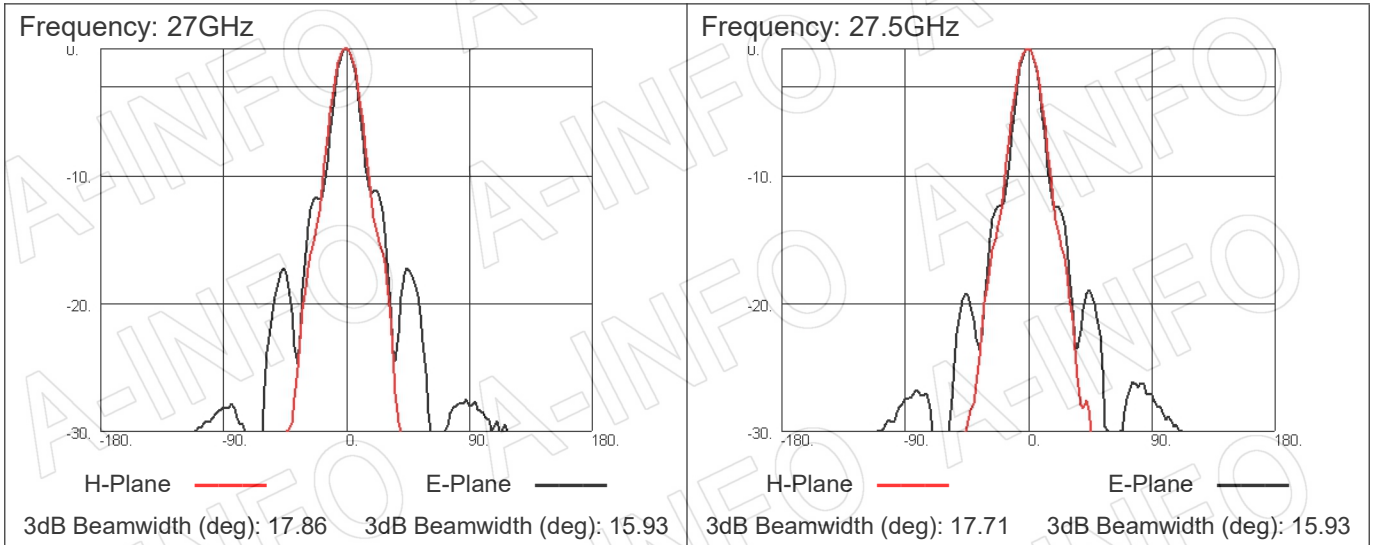

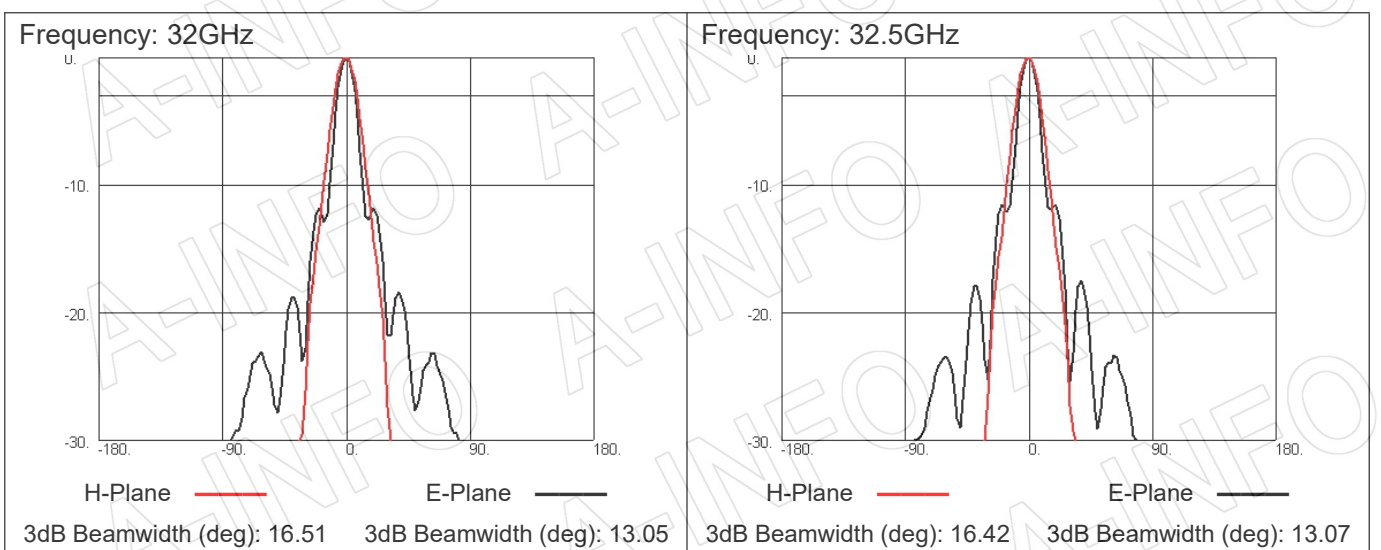
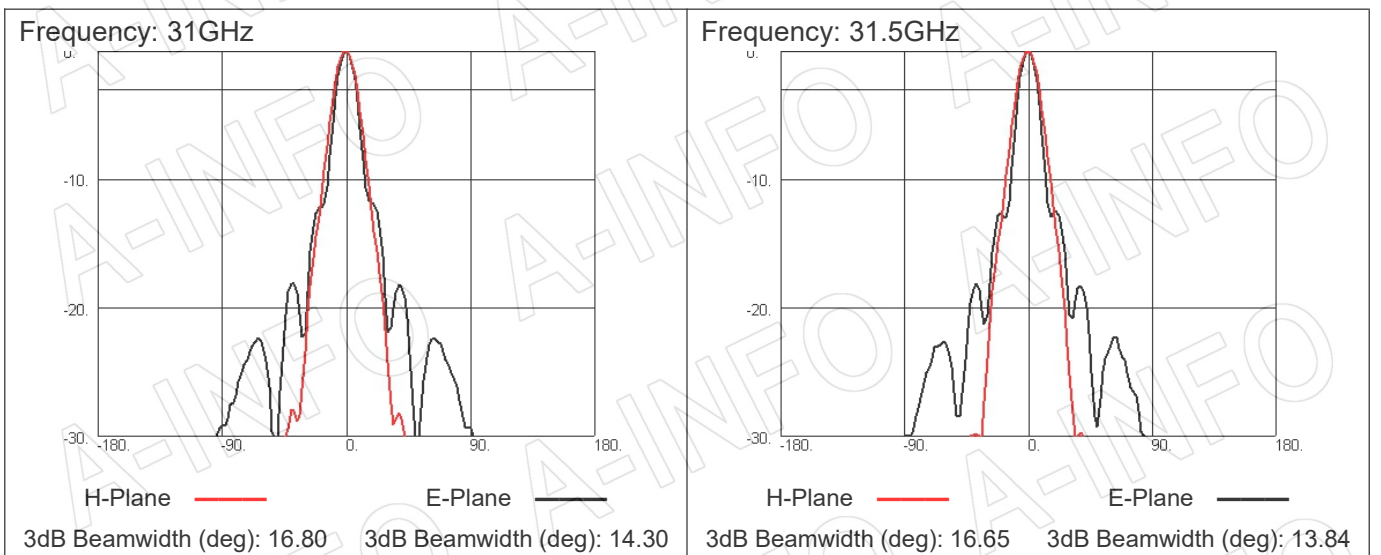
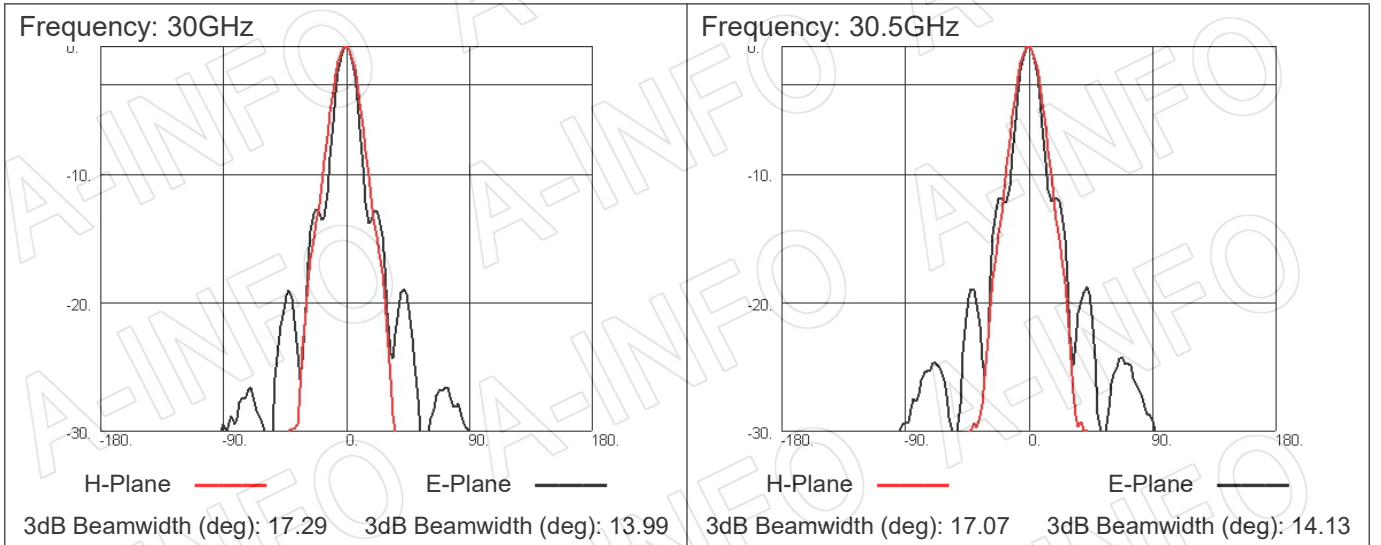

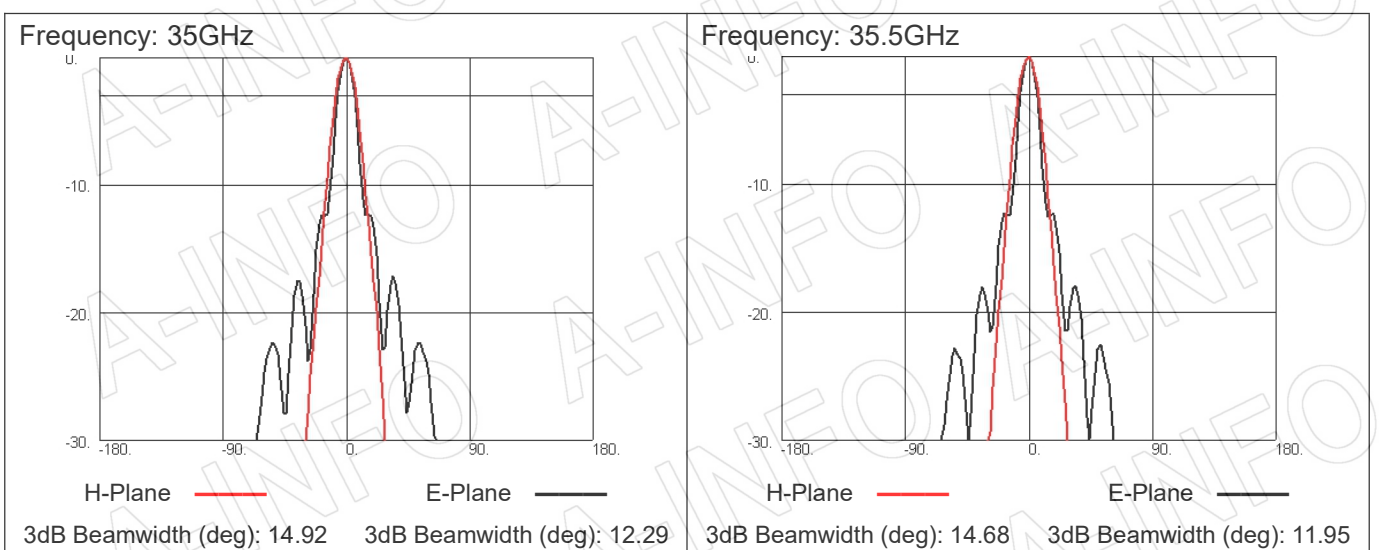
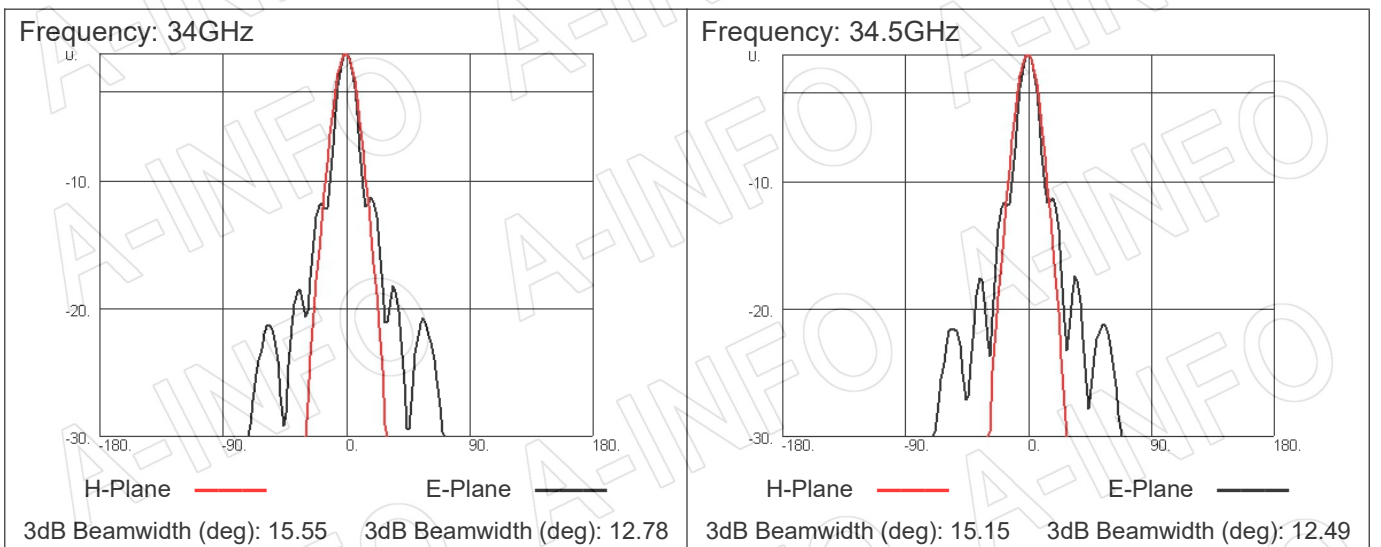
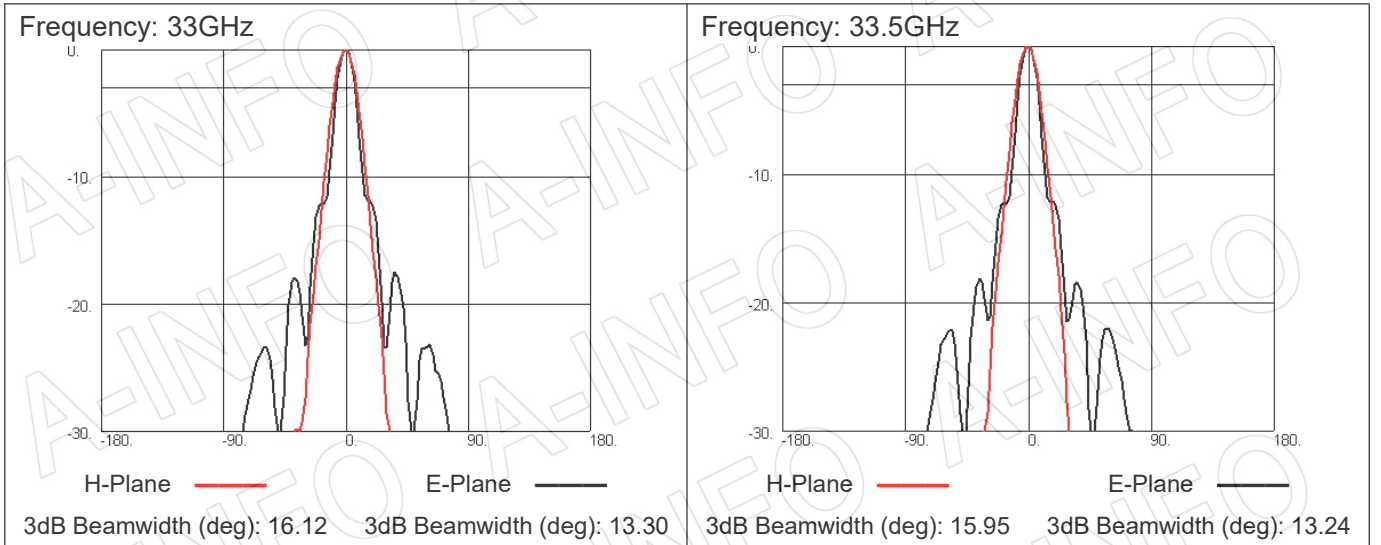

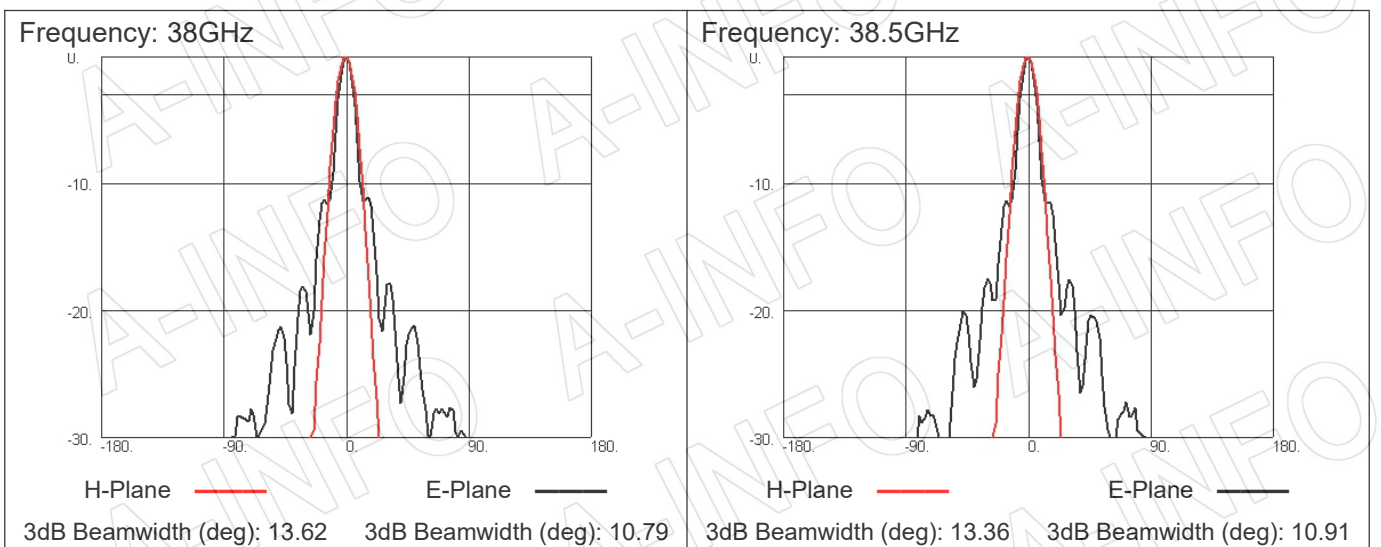
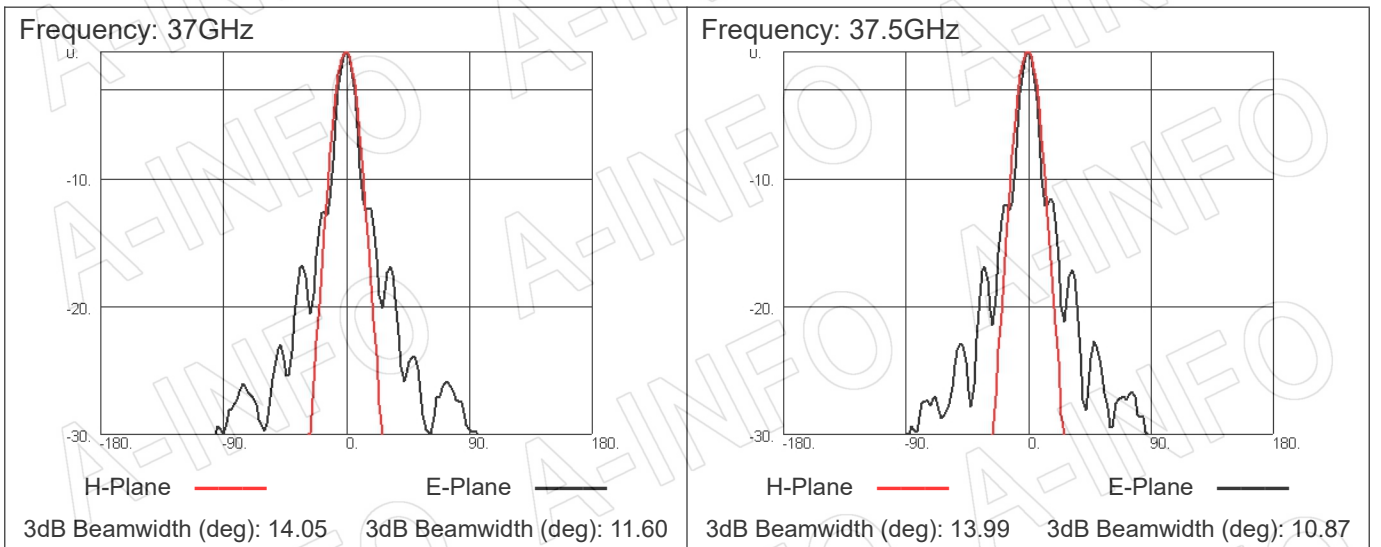
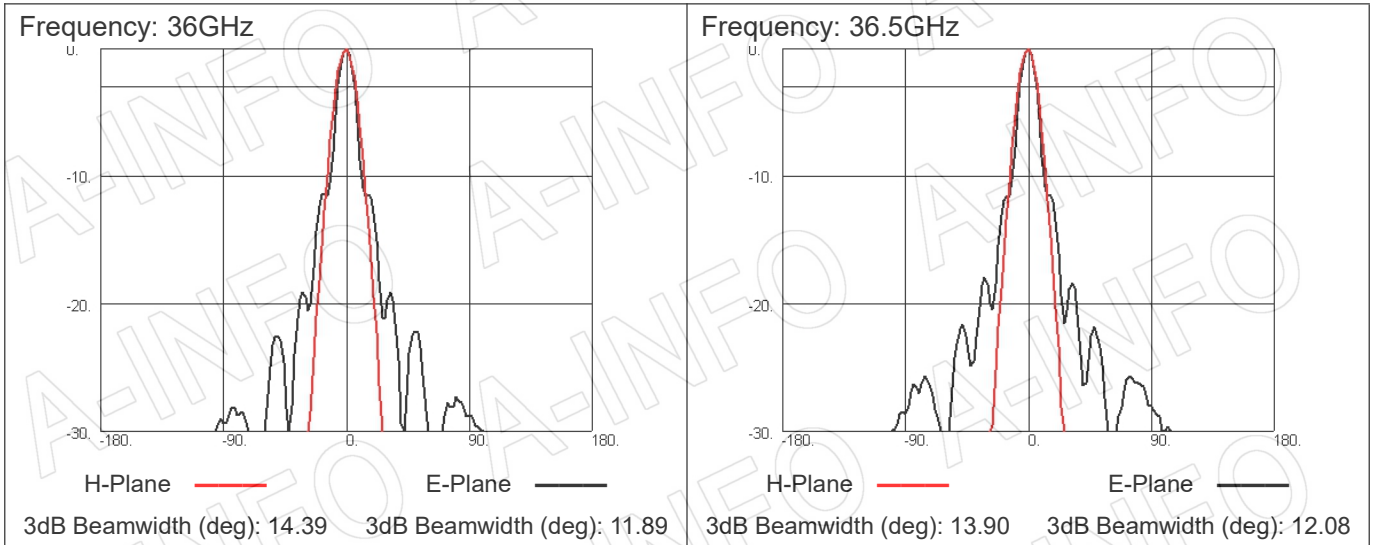

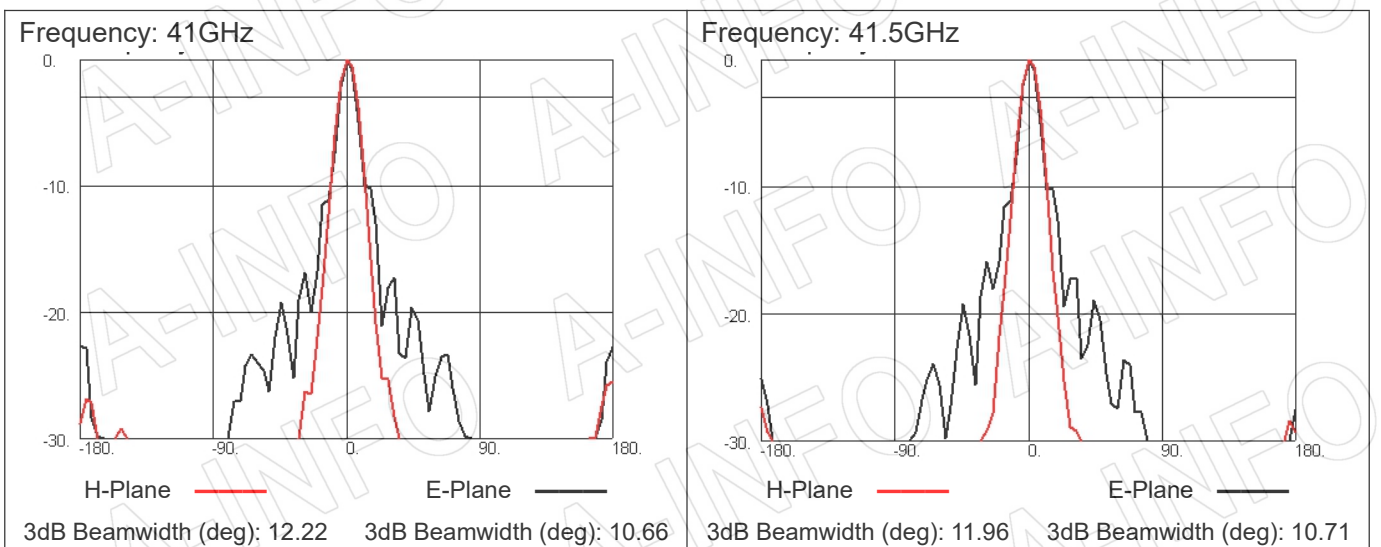
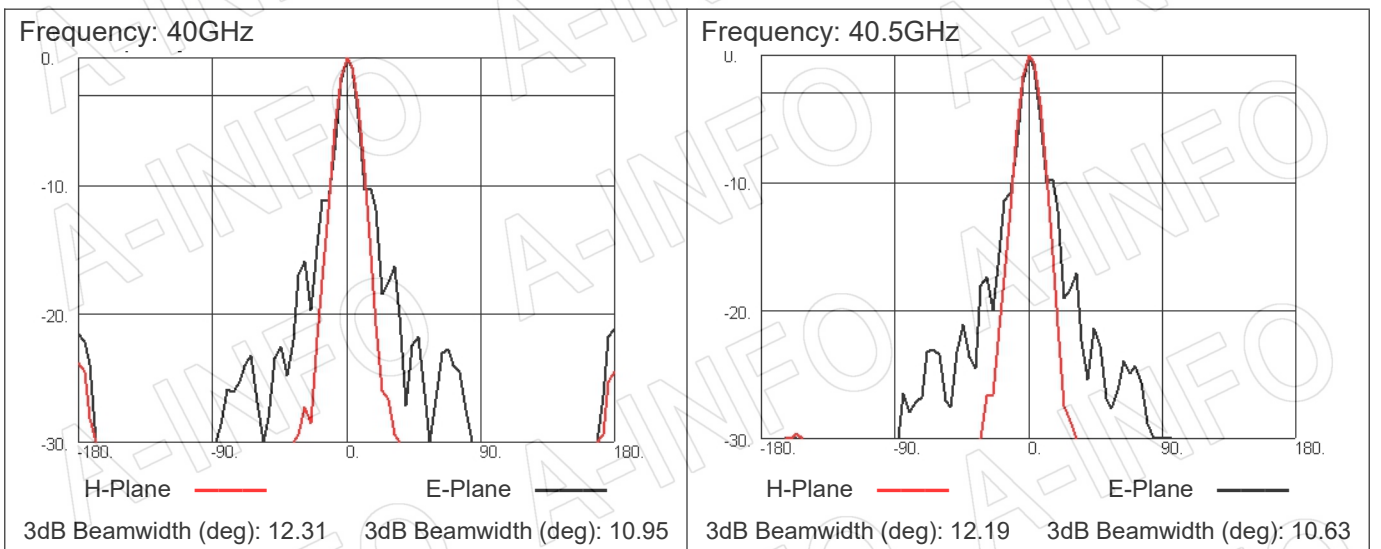
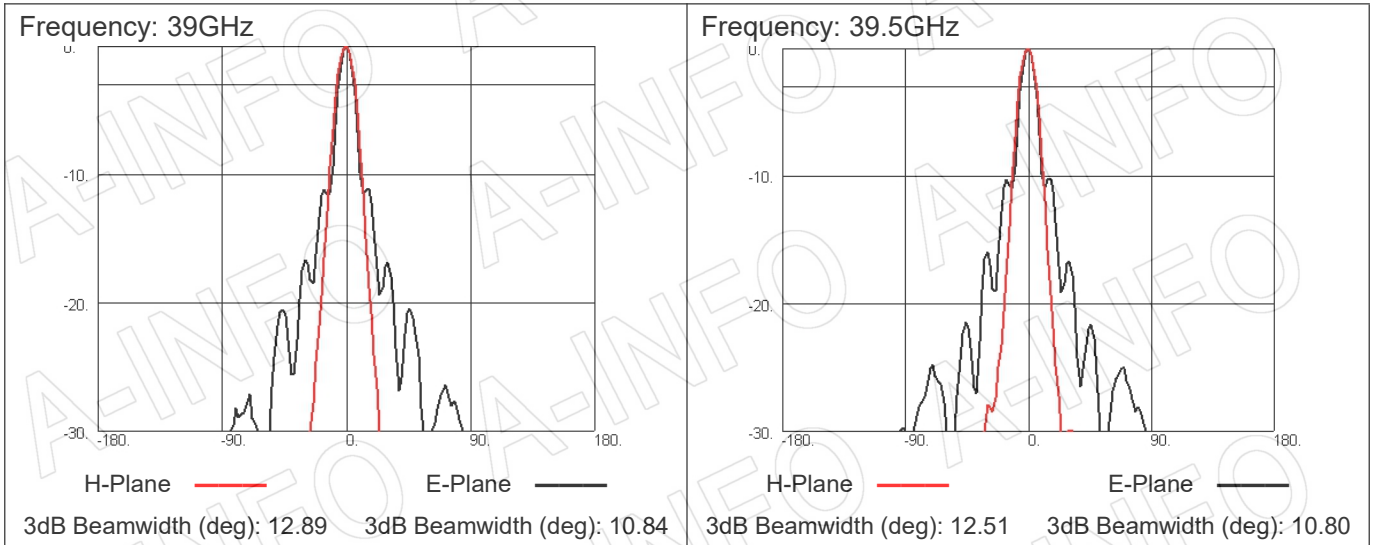

Frequency: 42GHz

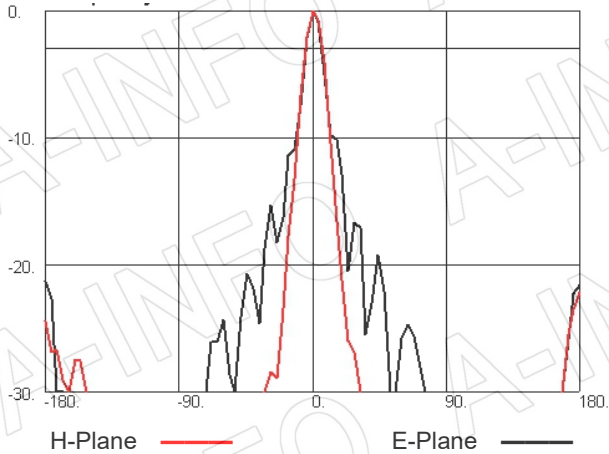

3dB Beamwidth (deg): 11.50    3dB Beamwidth (deg): 10.63

Frequency: 42.5GHz

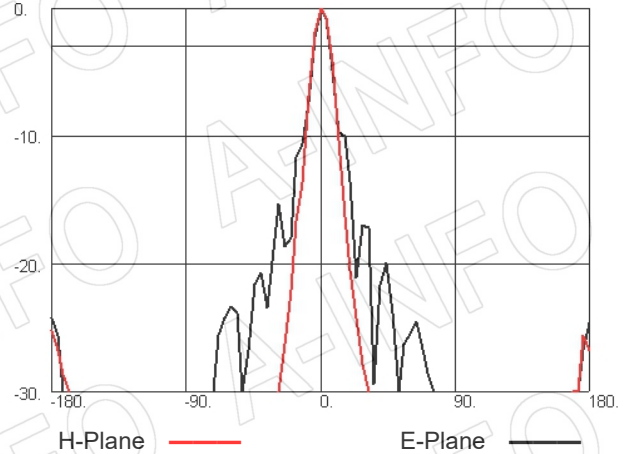

3dB Beamwidth (deg): 11.57    3dB Beamwidth (deg): 10.70

Frequency: 43GHz

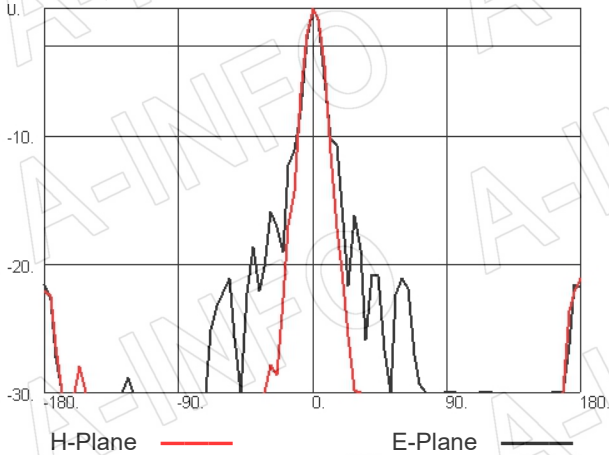

3dB Beamwidth (deg): 11.21    3dB Beamwidth (deg): 10.20

Frequency: 43.5GHz

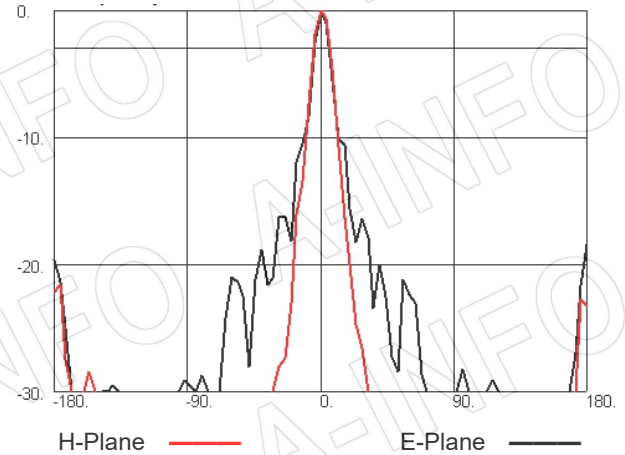

3dB Beamwidth (deg): 11.19    3dB Beamwidth (deg): 10.03

Frequency: 44GHz

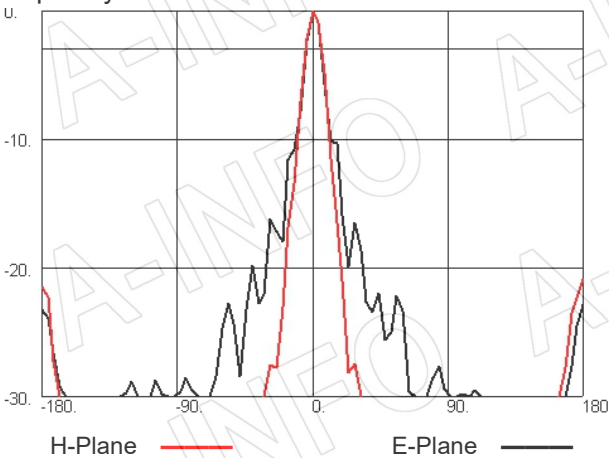

3dB Beamwidth (deg): 10.78    3dB Beamwidth (deg): 10.22

Frequency: 44.5GHz

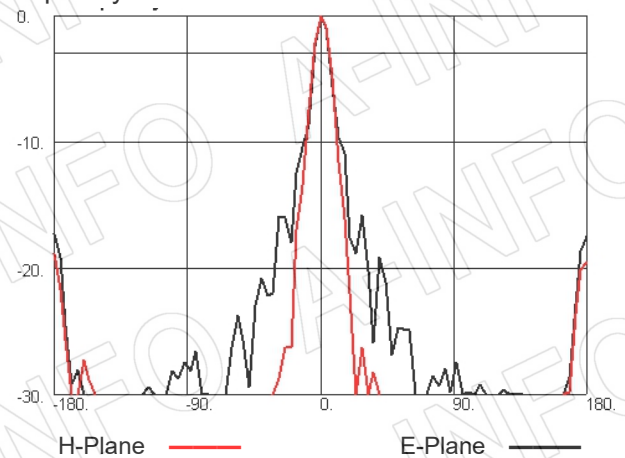

3dB Beamwidth (deg): 10.67    3dB Beamwidth (deg): 10.05

